

# HLS® 9000 Multipoint Sliding Door Handle Installation Instructions



A Phillips screwdriver, vise grips and pliers are required.

A Hex wrench for set screws is provided in the hardware package.

Use water and a soft cloth to clean. Do not use brass cleaner as it will remove the protective coating.

## Note:

Handles and backplates vary by style but application is the same.

Door Thickness Range	Tailpiece Score Mark
1.38" – 1.42" 35 mm – 36 mm	1
1.42" – 1.65" 36.1 mm – 42 mm	2
1.66" – 1.77" 42.1 mm – 45 mm	3

---

- For exterior backplates with optional cylinder, refer to the Door Thickness Range chart to determine what length of cylinder tailpiece to use. Using a vise grips and pliers, break the tailpiece at the appropriate tailpiece score mark.
- Determine handing. Slide handles into backplates so square corners of the handle neck match up with notches in backplate. Insert screw from back side of plate into handle neck and firmly tighten down with the included 6 mm hex wrench.
- Press a gasket onto the interior backplate. Insert the thumbturn shaft into the hub on the sliding door lock. Push the backplate mounting lugs into the mounting holes.
- Press a gasket onto the exterior backplate. Rotate the cylinder tailpiece away from the door edge as shown. Insert the cylinder tailpiece into thumbturn shaft slot. Push the backplate mounting lugs into the mounting holes.

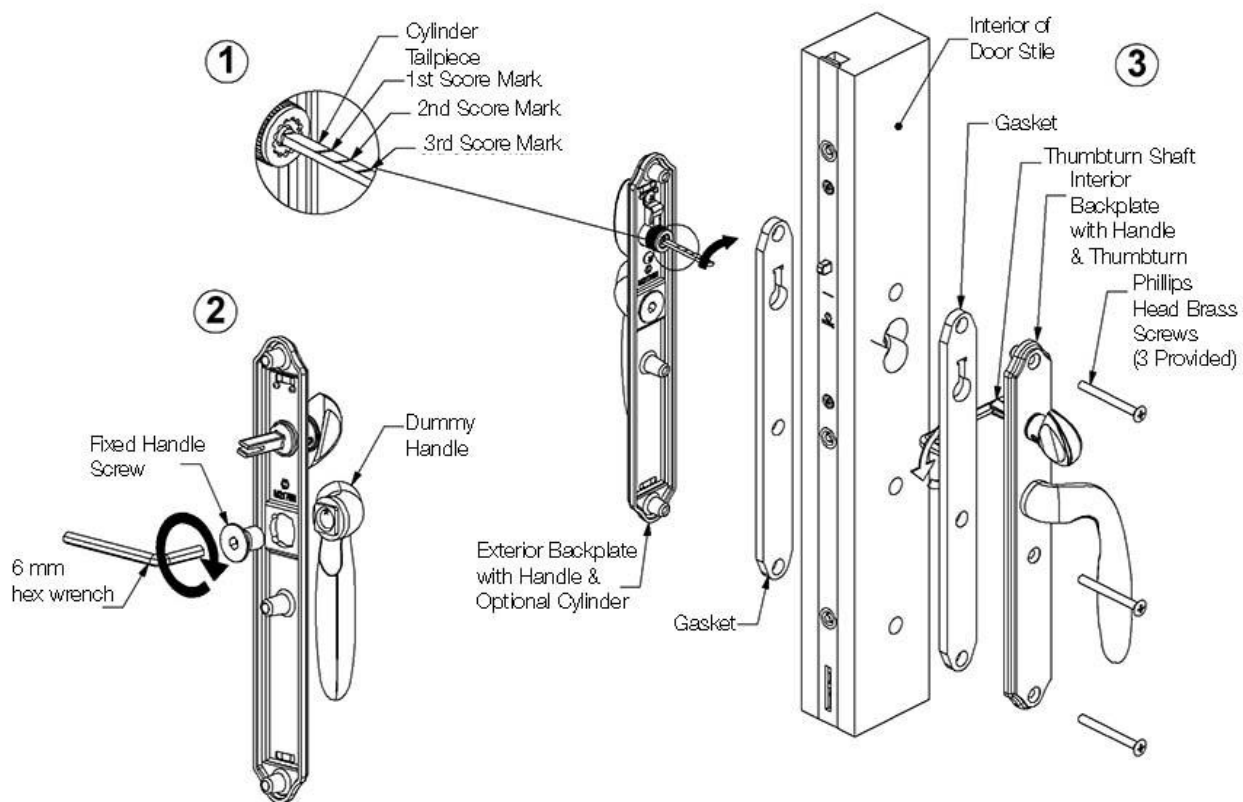

## Support

**Hardware Support** (<https://www.hoppe.com/us-us/door-handles/support/hardware-support/>)

Installation Support (<https://www.hoppe.com/us-us/door-handles/support/Installation-support/>)

Door Hardware Glossary (<https://www.hoppe.com/us-us/door-handles/support/door-hardware-glossary/>)